

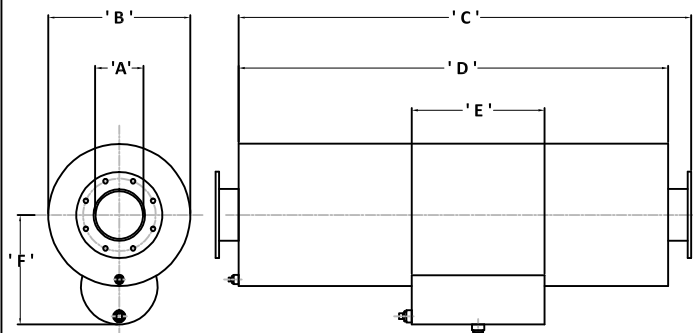

HPAA 2 Type: Expansion/Dissipative Spark Arrestor Exhaust Gas Silencers 35dB(A) Insertion Loss

AXIAL INLET & AXIAL OUTLET VERSIONS



Silencer Part Number	'A'	'B'	'C'	'D'	'E'	'F'	Wt. (kg)
HPAA2 050 (F & S)	50.8	210.0	1200.0	1050.0	180.0	155.0	14.5
HPAA2 063 (F & S)	63.5	260.0	1300.0	1150.0	180.0	205.0	23.5
HPAA2 075 (F & S)	76.2	260.0	1400.0	1250.0	180.0	225.0	34.5
HPAA2 090 (F & S)	88.9	310.0	1500.0	1350.0	230.0	275.0	40.0
HPAA2 100 (F & S)	101.6	360.0	1600.0	1450.0	280.0	275.0	50.0
HPAA2 125 (F)	127.0	410.0	1800.0	1650.0	280.0	300.0	67.0
HPAA2 150 (F)	152.4	460.0	2000.0	1850.0	430.0	355.0	106.0
HPAA2 175 (F)	177.8	510.0	2350.0	2200.0	430.0	380.0	138.0
HPAA2 200 (F)	203.2	560.0	2700.0	2550.0	430.0	405.0	170.0
HPAA2 225 (F)	228.6	610.0	2800.0	2650.0	430.0	430.0	190.0
HPAA2 250 (F)	254.0	660.0	2900.0	2720.0	430.0	455.0	300.0
HPAA2 300 (F)	304.8	760.0	3200.0	3020.0	430.0	505.0	515.0
HPAA2 350 (F)	355.6	920.0	3600.0	3420.0	585.0	605.0	718.0
HPAA2 400 (F)	406.4	1020.0	4000.0	3820.0	585.0	655.0	910.0
HPAA2 450 (F)	457.2	1170.0	4200.0	4000.0	585.0	730.0	1110.0
HPAA2 500 (F)	508.0	1270.0	4600.0	4400.0	736.0	810.0	1335.0
HPAA2 550 (F)	558.8	1370.0	5000.0	4800.0	736.0	855.0	1707.0
HPAA2 600 (F)	609.6	1470.0	5300.0	5000.0	736.0	930.0	2038.0

'S' denotes B.S.P. Screwed versions are available as standard.
 'F' denotes Flanged versions are available in BS 10 Table 'D' drillings as standard.
 All dimensions given are in millimeters.
 All weights stated are in kilograms.
 All the dimensions and weights given are approximate and may vary under manufacturing conditions.
 All dimensions and weights given are not binding and may change without prior warning.
 All units can be installed vertically, horizontally without detriment acoustically.
 Acoustic treatment of the primary chamber casing available, if required.

RADIAL INLET & AXIAL OUTLET VERSIONS

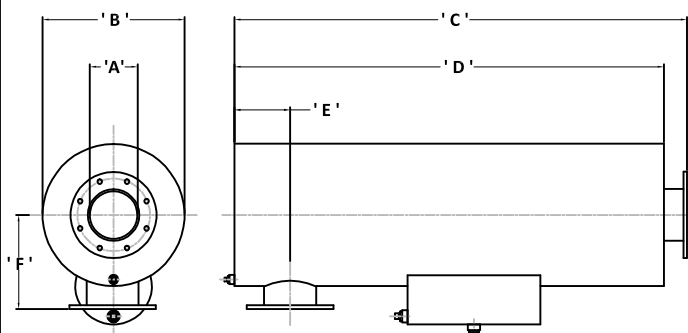

Silencer Part Number	'A'	'B'	'C'	'D'	'E'	'F'	Wt. (kg)
HPAA2-SE 050 (F & S)	50.8	210.0	1125.0	1050.0	50.0	180.0	15.0
HPAA2-SE 063 (F & S)	63.5	260.0	1225.0	1150.0	60.0	205.0	24.5
HPAA2-SE 075 (F & S)	76.2	260.0	1325.0	1250.0	70.0	205.0	35.5
HPAA2-SE 090 (F & S)	88.9	310.0	1425.0	1350.0	75.0	230.0	41.0
HPAA2-SE 100 (F & S)	101.6	360.0	1525.0	1450.0	90.0	255.0	52.0
HPAA2-SE 125 (F)	127.0	410.0	1725.0	1650.0	110.0	280.0	69.0
HPAA2-SE 150 (F)	152.4	460.0	1925.0	1850.0	130.0	305.0	108.0
HPAA2-SE 175 (F)	177.8	510.0	2275.0	2200.0	145.0	330.0	140.0
HPAA2-SE 200 (F)	203.2	560.0	2625.0	2550.0	165.0	355.0	175.0
HPAA2-SE 225 (F)	228.6	610.0	2725.0	2650.0	175.0	380.0	195.0
HPAA2-SE 250 (F)	254.0	660.0	2810.0	2720.0	185.0	420.0	305.0
HPAA2-SE 300 (F)	304.8	760.0	3110.0	3020.0	210.0	470.0	518.0
HPAA2-SE 350 (F)	355.6	920.0	3510.0	3420.0	250.0	550.0	721.0
HPAA2-SE 400 (F)	406.4	1020.0	3910.0	3820.0	280.0	600.0	915.0
HPAA2-SE 450 (F)	457.2	1170.0	4100.0	4000.0	270.0	685.0	1115.0
HPAA2-SE 500 (F)	508.0	1270.0	4500.0	4400.0	300.0	735.0	1345.0
HPAA2-SE 550 (F)	558.8	1370.0	4900.0	4800.0	330.0	785.0	1720.0
HPAA2-SE 600 (F)	609.6	1470.0	5150.0	5000.0	360.0	885.0	2050.0

The 'F' dimension is variable anywhere between the two dimensions given in millimeters.
 All units are manufactured from mild carbon steel to BS-EN 10025 S275JR or equal.
 The standard external protection is one coat heat resisting aluminium paint suitable for elevated temperatures. Alternative finishes including such processes as Aluminium/Zinc metal spray and galvanizing are available at extra cost, if required.
 Alternative materials of construction are available if required. These include stainless steel Types 321, 316, 316L, 304 304L as well as Corten A & B, Monel & Brass
 All units are supplied with drain points.
 Add 100.0mm to Dimension 'B' for acoustically treated versions

TYPICAL INSERTION LOSS FIGURES FOR HPAA-2 & HPAA2-SE TYPE UNITS (Not Binding)

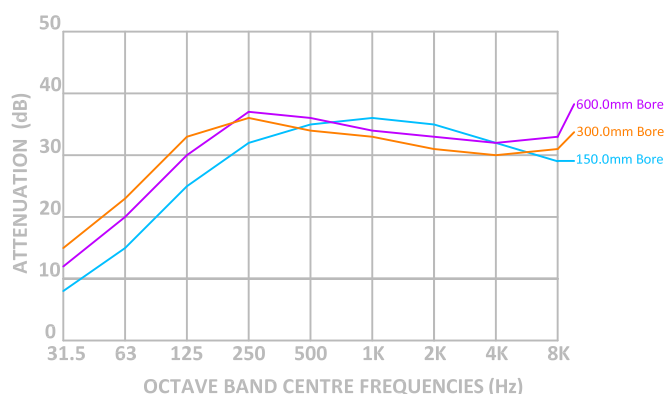

The HPAA2 & HPAA2-SE (Side-Entry) type, spark arrestor exhaust gas silencer, utilizes both the low and middle frequency expansion/reflection principles as well as the high frequency dissipative techniques of the mineral fibre packed straight line silencer. These complimentary energy conversion systems offer one of the highest conversion rates of noise energy into heat energy currently available and the surplus heat is then carried away by the silencer casing or the gas flow into the surrounding atmosphere. The two concepts acting together provide a design that gives a good broad spectrum coverage in all the octave band frequencies resulting in an overall noise reduction capability of approximately 35dB(A) dependant upon the engine firing frequency and power output of the main driver concerned, with a slightly lower pressure drop than the standard HPA series of silencers

The equipment can be used as a stand alone silencer on a varied range of applications, where noise is regarded as a major contributing factor. As the exacting spark arresting performance meets the requirements of EEC 98/37/EC and BS-EN 1834-1 and all their amendments. The design is ideal for use in the majority of hazardous on-shore based power generation applications, as well as a multitude of off-shore marine installations. The HPAA2 denomination can also be close coupled or remotely mounted to a HSL, HESL or HXSLS series, dissipative silencer to reduce exhaust gas noise to a relatively low, much more acceptable emission level suitable for any environment where the specifications so dictate.

The whole range can be supplied in a variation of austenitic stainless steel options if requested.

Consult PGS Engineering Staff for further details prior to order.