

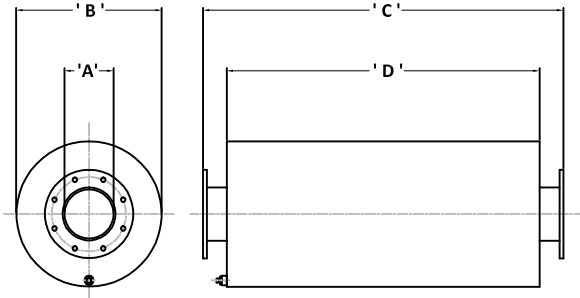

HP 5 A/T Type:Expansion/Resonator Exhaust Gas Silencers.

38dB(A) Insertion Loss

AXIAL INLET & AXIAL OUTLET VERSIONS



Silencer Part Number	'A'	'B'	'C'	'D'	Wt. (kg)
HP5 038 (F & S)	38.1	360.0	950.0	800.0	9.8
HP5 050 (F & S)	50.8	410.0	1050.0	900.0	16.5
HP5 063 (F & S)	63.5	460.0	1150.0	1000.0	39.0
HP5 075 (F & S)	76.2	510.0	1350.0	1200.0	49.0
HP5 090 (F & S)	88.9	560.0	1350.0	1200.0	68.0
HP5 100 (F & S)	101.6	560.0	1650.0	1500.0	88.0
HP5 125 (F)	127.0	660.0	1700.0	1520.0	128.0
HP5 150 (F)	152.4	760.0	2000.0	1720.0	195.0
HP5 175 (F)	177.8	810.0	2300.0	2120.0	225.0
HP5 200 (F)	203.2	860.0	2620.0	2420.0	285.0
HP5 225 (F)	228.6	910.0	2860.0	2680.0	355.0
HP5 250 (F)	254.0	1000.0	3000.0	2820.0	545.0
HP5 300 (F)	304.8	1000.0	3700.0	3500.0	695.0
HP5 350 (F)	355.6	1120.0	3700.0	3500.0	860.0
HP5 400 (F)	406.4	1250.0	4200.0	4000.0	1060.0
HP5 450 (F)	457.2	1370.0	4800.0	4600.0	1340.0
HP5 500 (F)	508.0	1470.0	5500.0	5300.0	1610.0
HP5 550 (F)	558.8	1630.0	5850.0	5650.0	1880.0
HP5 600 (F)	609.6	1730.0	6650.0	6350.0	2420.0

'S' denotes B.S.P. Screwed versions are available as standard.
 'F' denotes Flanged versions are available in BS 10 Table 'D' drillings as standard.
 All dimensions given are in millimeters.
 All weights stated are in kilograms.
 All the dimensions and weights given are approximate and may vary under manufacturing conditions.
 All dimensions and weights given are not binding and may change without prior warning.
 All units can be installed vertically, horizontally without detriment acoustically.
 Acoustical treatment to primary and secondary chambers available, if required.

RADIAL INLET & AXIAL OUTLET VERSIONS

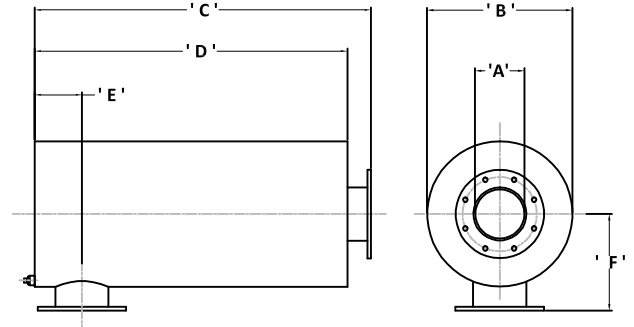

Silencer Part Number	'A'	'B'	'C'	'D'	'E'	'F'	Wt. (kg)
HP5-SE 038 (F & S)	38.1	360.0	875.0	800.0	45.0/ 380.0	255.0	9.5
HP5-SE 050 (F & S)	50.8	410.0	975.0	900.0	50.0/ 430.0	280.0	16.0
HP5 -SE063 (F & S)	63.5	460.0	1075.0	1000.0	70.0/ 450.0	305.0	32.0
HP5-SE 075 (F & S)	76.2	510.0	1275.0	1200.0	80.0/ 600.0	325.0	45.0
HP5-SE 090 (F & S)	88.9	560.0	1295.0	1220.0	90.0/ 600.0	355.0	65.0
HP5-SE 100 (F & S)	101.6	560.0	1575.0	1500.0	95.0/ 725.0	355.0	85.0
HP5-SE 125 (F)	127.0	660.0	1775.0	1700.0	110.0/ 800.0	405.0	145.0
HP5-SE 150 (F)	152.4	760.0	2075.0	2000.0	120.0/ 850.0	455.0	190.0
HP5-SE 175 (F)	177.8	810.0	2195.0	2120.0	135.0/1000.0	480.0	240.0
HP5-SE 200 (F)	203.2	860.0	2515.0	2440.0	145.0/1100.0	505.0	290.0
HP5-SE 225 (F)	228.6	910.0	2755.0	2680.0	165.0/1200.0	530.0	345.0
HP5-SE 250 (F)	254.0	1000.0	2910.0	2820.0	180.0/1250.0	590.0	440.0
HP5-SE 300 (F)	304.8	1000.0	3610.0	3520.0	205.0/1500.0	590.0	600.0
HP5-SE 350 (F)	355.6	1120.0	3610.0	3520.0	255.0/1600.0	630.0	780.0
HP5-SE 400 (F)	406.4	1250.0	4100.0	4000.0	290.0/1650.0	715.0	960.0
HP5-SE 450 (F)	457.2	1370.0	4700.0	4600.0	320.0/2100.0	785.0	1160.0
HP5-SE 500 (F)	508.0	1470.0	5400.0	5300.0	345.0/2400.0	835.0	1500.0
HP5-SE 550 (F)	558.8	1630.0	5750.0	5650.0	365.0/2600.0	915.0	1870.0
HP5-SE 600 (F)	609.6	1730.0	6500.0	6350.0	380.0/2850.0	965.0	2340.0

The 'F' dimension is variable anywhere between the two dimensions given in millimeters.
 All units are manufactured from mild carbon steel to BS-EN 10025 S275JR or equal.
 The standard external protection is one coat heat resisting aluminium paint suitable for elevated temperatures. Alternative finishes including such processes as Aluminium/Zinc metal spray and galvanizing are available at extra cost, if required.
 Alternative materials of construction are available if required. These include stainless steel Types 321, 316, 316L, 304 304L as well as Corten A & B, Monel & Brass
 All units are supplied with drain points.

TYPICAL INSERTION LOSS FIGURES FOR HP5 & HP5-SE TYPE UNITS (Not Binding)

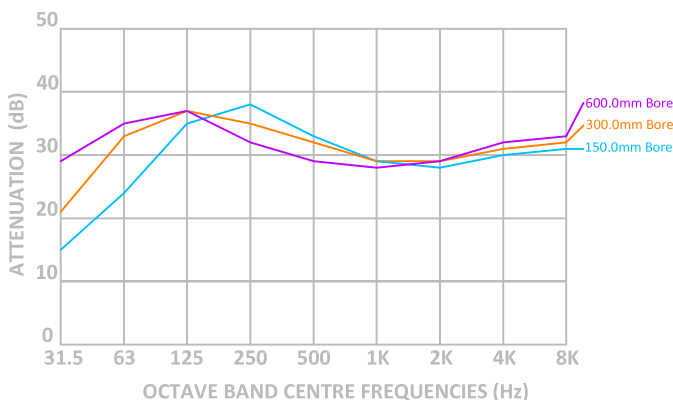

The HP5 & HP5-SE (Side-Entry) type is the largest exhaust gas silencers currently available. The two/three chamber design a simple energy converter again utilizing the exhaust gas velocity and differing volumes to create rapid changes in velocity resulting in noise energy conversion into heat which is then dissipated to the silencer casing. The design also uses the reflective principles well known in acoustic work to bounce dominant frequencies back on themselves canceling each other out. This increases the insertion loss at the lower frequencies including the fundamental firing frequency to give a silencer with higher pressure drop and excellent capabilities at the low to middle frequency range.

It can be used singularly as a primary silencer on sensitive applications such as schools, hospitals & hotels, as well as power generation plants close to heavily populated areas. It is fundamentally used on installations where noise is perceived as a definite problem to local surroundings. Due to the effect on the lower frequencies this design is mainly used as a primary silencer for both land based power generation applications as well as various marine uses. The design can also be close coupled or remotely mounted to a HSL5 or HSL5-SE series dissipative silencer to reduce exhaust gas noise to a lower more acceptable emission level suitable for any environment. The design can also be used in a modified state on rotary/ centrifugal compressors, blowers and other equipment. Consult PGS LTD Engineering Staff for further details prior to order.